

OPTIONAL LEAF FINISHES

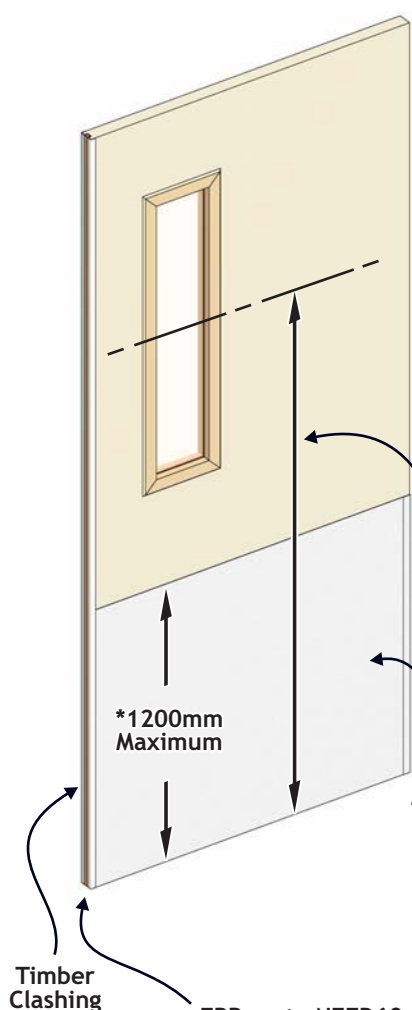

| <i>Facing</i> | <i>FRR up to NZFD60</i> | <i>NZFD60E to NZFD240E</i> |
|-----------------------|-------------------------|----------------------------|
| Timber Veneers | Approved | Approved |
| Formica 1mm | Approved | Flame Retardant** |
| Acrovyn 1.8mm | Approved* | Approved* |
| Steel | Approved* | Approved |
| Steel Clad and Capped | | Approved |
| Corner Protectors | Aluminium | Steel |

Aluminium meeting stiles, if specified, protect double doors.

* 1200mm Maximum or underside of vision panel bead - see diagram at left.

** Maximum -/90/30 on double acting doors. Can be added to edge strips on hinged doors if full height.

Typically 1400mm to centre of glazing. Refer also leaf edge and hardware clearance restrictions in Section 9

Kick-plates and impact protection facings, adhesive fixed. Reduce width if corner protectors are to be fitted.

Timber Clashing

FRR up to NZFD60
Aluminium Corner Protector Option
to full height of leaf.

NZFD60E to NZFD240E
1mm Steel Capping Channel Option
to height of steel kick-plate only.

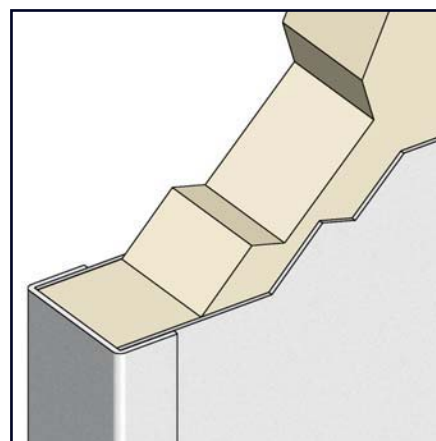
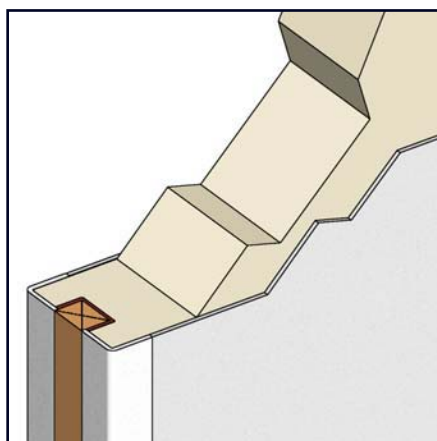

Also available from
Metalbilt, Auckland
 Ph: 09-828 1167, Fx: 09-828 6358
Metalbilt, Wellington
 Ph: 04-568 2933, Fx: 04-568 7337
Metalbilt, Christchurch
 Ph: 03-338 2600, Fx: 03-338 4386

NZ FIRE DOORS
 PO Box 12709, Auckland 1642
 89 Gavin Street, Ellerslie
 Ph: 09-579 8895
 Fx: 09-579 2933
 Email: sales@nzfiredoors.co.nz
 www.nzfiredoors.co.nz
 Norfolk Building Products Limited