



TEL: 09 579-8895
FAX: 09 579-2933
EMAIL: sales@nzfiredoors.co.nz

NZ Fire Doors Ltd,
89 Gavin Street, Ellerslie,
PO Box 12709, Penrose 1642,
Auckland, New Zealand.
www.nzfiredoors.co.nz

Data sheet

I-30-H: Interior 30 minute FRR hung door, single or pair

Our most popular 30 minute FRR interior fire, smoke and acoustic door set, the I-30-H is available in singles or pairs. The door leaf is a solid composite timber core faced with an integral MDF layer (S-CORE). The standard door set is supplied sealer coated on both faces, as well as top and bottom, or you can specify a facing and/or kickplate.

- Leaf sizes up to 2030 high x 1200 wide or 2700 high x 900 wide per leaf
- Thickness 45mm
- Weight 19.8 kg /m²
- Acoustic singles and doubles up to STC 33

- Leaf sizes up to 2350 high x 1200 wide or 2700 high x 1200 wide per leaf
- Thickness 55 mm
- Weight 28.2 kg /m²
- Acoustic singles and doubles up to STC 34

FACING OPTIONS

- Paint quality factory sealed
- Timber veneer full height
- High pressure laminate full height
- Vinyl to 1000 mm
- 1 mm stainless steel kickplate to 1000 mm – both sides

LEAF EDGE DETAILS

- 7 mm pine clashing to hinge edge/s
- 7 mm pine clashing to leading edge (Flush pairs & Singles)
- Bullnose (Ali)

PAIR MEETING STYLES

Timber (the standard option)

Flush

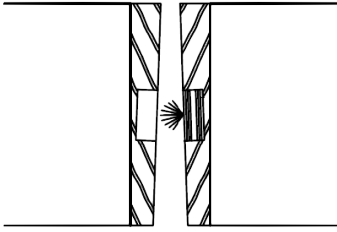

Aluminium (surcharge applies)

Bullnose C/C

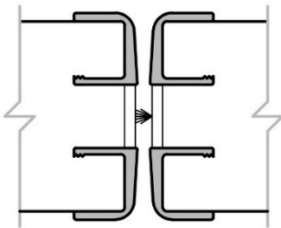

JAMB TYPES AND PROFILES

30 - 32 mm PQ timber (types 1, 2 & 3), width 81 – 350mm, with (30 x 12) planted stops, full width available at extra cost (other timber options available by request) or 1.6 mm electrogalv steel (types 5, 6, 7, paint quality or powdercoat options available)

T1 – Timber

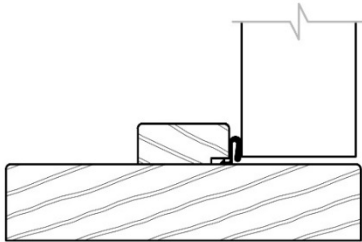

Timber flat for architrave

T2 - Timber

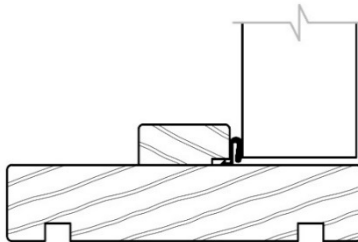

Grooved for wall lining to suit (12 mm reveals)

T3 - Timber

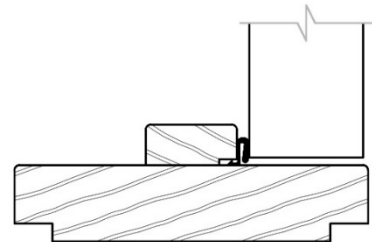

Rebated for wall lining to suit (non-standard surcharge may apply)

Timber – Full Width planted stop

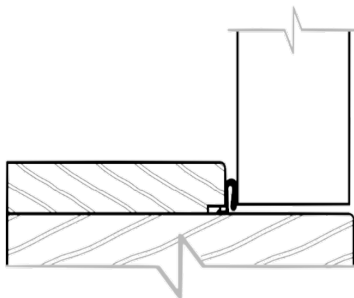

Available for all timber profiles (non- standard surcharge applies)

T2 - Timber

T3 - Timber

The minimum requirement is for a fire door to be self-closing and self-latching. Hardware must be selected from NZ Fire Doors' Approved Hardware list from the column '30 min'. Fitting any hardware that inhibits self-closing or self-latching is not approved by NZS 4520

IMPORTANT: Fitting untested or inappropriate hardware may affect the performance of the door and will void the warranty.